

GEORGE T. DUNHAM  
SURVEYING & SUBDIVIDING  
DELAVER, WISCONSIN

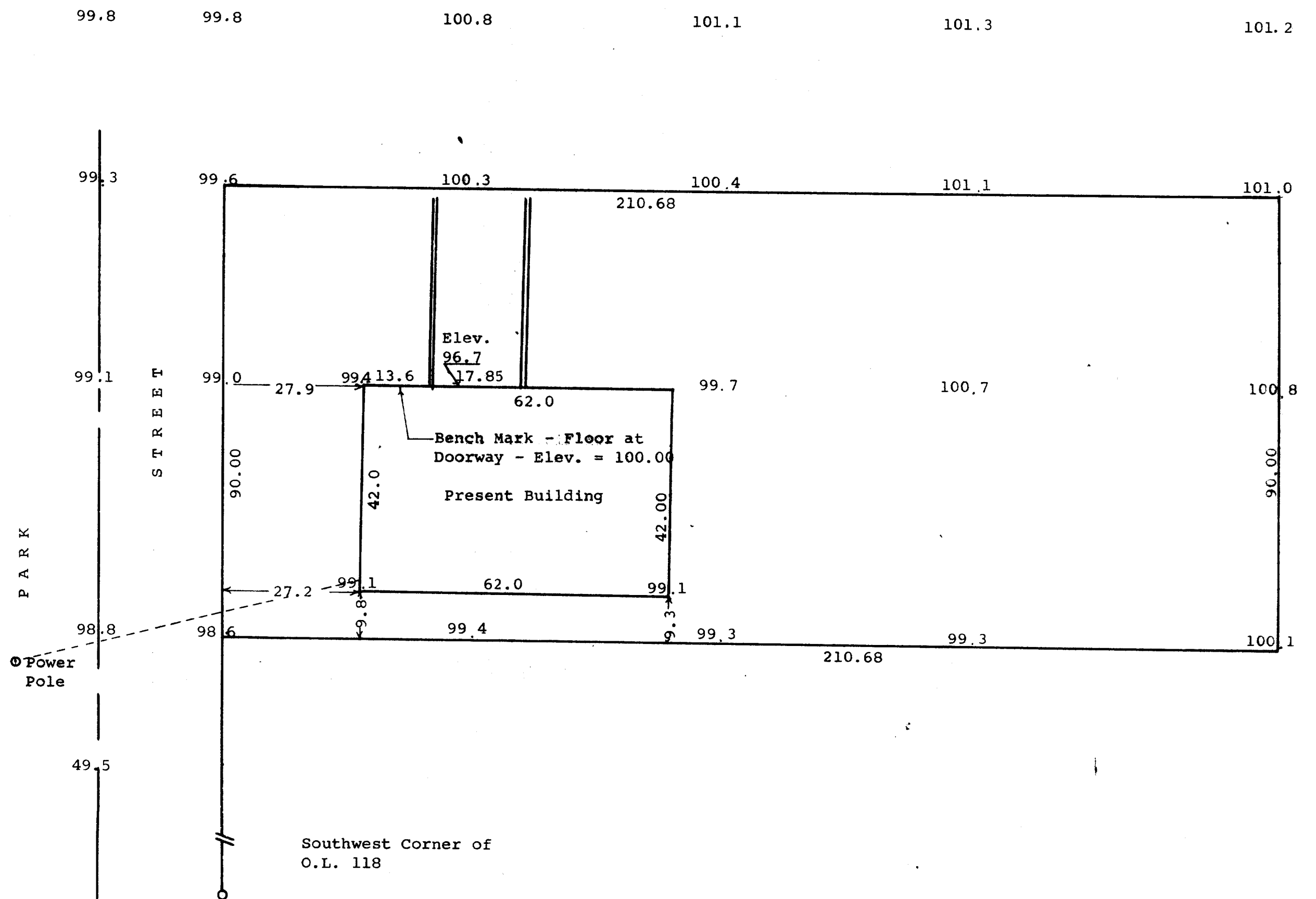

Plat showing the location of the improvements on a parcel of land described as follows,

Beginning at a point on the East line of Park Street in the Village of Walworth 109 feet north of the Southwest corner of Outlot 118 of the Assessor's Plat of the Village of Walworth (said point being also the northwest corner of property heretofore conveyed by the Village of Walworth to Earl Quass); thence East parallel to the South line of said Outlot 118 - 210.68 feet; thence North parallel to the west line of Park Street 90 feet; thence west parallel to the south line of Outlot 118 to the East line of Park Street; thence South along the East line of Park Street 90 feet more or less to the place of beginning.

April 6, 1964

*George T. Dunham*  
George T. Dunham, Surveyor